

Operating Instructions

EN KNIPEX Tethered Tool System

Lanyards

Adapter Straps

KNIPEXTEND TetheredTool Clips (TTC)

KNIPEX Tethered Tools

00 50 05 T BKA

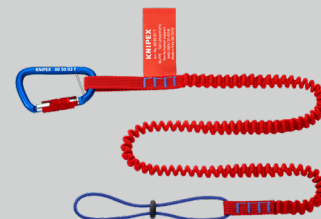

00 50 06 T BKA



00 50 12 T BKA



00 50 13 T BKA



00 62 10 TR



00 63 06 TCR



CONTENTS

1	Safety Information	3
1.1	KNIPEX Tethered Tools Lanyards, Adapter Straps, and TetheredTool Clips (TTC) should be used only as recommended in these instructions. Failure to follow recommendations can result in serious injury, death, or damage to equipment and property.	3
1.2	Intended use	3
1.3	Safety Instructions for operation.....	3
	Risk of falling onto a lower surface or an object.....	3
	Risk of injury from moving parts	3
	Risk of injury from falling parts.....	3
2	Design and function	5
2.1	Design and capacity of the Lanyard and Adapter Strap for KNIPEX tools up to 3.3 lbs. (1.5 kg).....	5
2.2	Design and capacity of the Lanyard and Adapter Strap for tools up to 13 lbs. (6 kg).....	5
2.3	Function 5	
3	Operation.....	6
3.1	Connecting the Lanyard to the tool.....	6
3.1.1	Attaching the KNIPEXTEND Tethered Tool Clip (TTC) to the KNIPEX tool with 3 Component Comfort Handles with Slots.....	6
	Warning – damaged components.....	6
	Warning - incompatible components	6
3.1.2	Connecting the 3.3 lbs. (1.5 kg) Lanyard and / or Adapter Strap when using the KNIPEXTEND TetheredTool Clip (TTC) and the KNIPEX Engineered Tether Point – Part # 00 50 05 T BKA & 00 50 06 T BKA.....	7
3.2	Connecting the 13 lbs. (6 kg) Lanyard to primary anchoring locations (body, lifting device, or structure)	7
3.3	Using the tethering system	7
3.4	Using the abridged connection point	8
4	Inspection	9
5	Storage and Care	10
6	Product Overview and Technical Data	10
6.1	KNIPEXTEND TetheredTool Clips (TTC) and ColorCode Clips (CCC).....	10
6.2	Lanyards and Adapter Straps with Captive Eye Carabiner.....	10
7	Certified Safety	10
8	Compatibility to KNIPEX Tools with Tethering.....	11

IMPORTANT SAFETY INFORMATION

Read and Save These Instructions

1 Safety Information

1.1 KNIPEX Tethered Tools Lanyards, Adapter Straps and TetheredTool Clips (TTC) should be used only as recommended in these instructions. Failure to follow recommendations can result in serious injury, death, or damage to equipment and property.

1.2 Intended use

The products are intended for the following uses:

- All elements of the KNIPEX Tethered Tools System are designed to be used only with Tethered tools and for tool tethering only.
- In use, the tethering system should be connected to a secure anchor point, which may be a secure, closed loop (such as a D-ring) on a belt or harness or a structural anchor point that is a part of or securely attached to a structure or stable equipment.

Users must be trained about tool securing and the safe use of tools at heights. In order to reduce the hazards of working at heights with tools, the following instructions must be followed:

1.3 Safety Instructions for operation

▲ DANGER

Risk of falling onto a lower surface or an object

- KNIPEX Tethered Tool Lanyards and Adapter Straps are for tool tethering only. They are not for human support, nor are they intended to be part of a human fall protection system. The tethering system may not be used for human support. Such use can cause components to break or fail causing a fall.

▲ WARNING

Risk of injury from moving parts

- Do not use around machinery with exposed turning or moving parts. The tethering system or an attached tool could become entangled in the machinery and cause injury.

Risk of injury from falling parts

- Never exceed the maximum capacity for any tethering system component. See Section 2.
- Do not connect any tool with a weight greater than 5 lbs. (2.26 kg) to your body. Secure heavier tools to a suitable, fixed anchor point.
- Never attach more than one tool to a Lanyard or Adapter Strap at the same time.
- Each Lanyard or Adapter Strap **MUST** be inspected prior to each use as described in these instructions.
- Do not use the TetheredTool Clip if the handle of the tool or the slot is damaged.
- KNIPEX tools with a fixed tethered attachment point on the handle **MUST** be inspected prior to each use.
- Do not alter or modify any component of the tethering system.
- If a Lanyard or Adapter strap has been subjected to fall arrest forces (the forces of a tool dropped to the full extent of the tethering system or forces imposed if the tethering system has supported the weight of a heavy object), it must be immediately inspected for damage prior to continued use. (See Section 4 Inspection).
- Do not make modifications to Lanyards, Adapter Strap, TetheredTool Clips and KNIPEX Tethered Tools.
- Do not tie or knot a Lanyard or Adapter Strap. Lanyards and Adapter Straps should be attached only as provided in these instructions.
- Do not lengthen a Lanyard by connecting multiple lanyards together.
- Do not connect more than one Adapter Strap to the Lanyard.

- Do not connect more than two Adapter Straps together.
- Ensure the Lanyard or Adapter Strap is kept free from obstructions and entanglements, including other workers, yourself, and other equipment.
- Do not wrap Lanyards or Adapter Straps around sharp or abrasive edges.
- Do not use a Lanyard or Adapter Strap if it will interfere with the safe working conditions or operation of the tool or equipment it is attached to.
- Lanyards or Adapter Straps should only be connected to anchor points suitable and reliable for tool tethering.
- Lanyards or Adapter Straps should only be connected to tools with captive (closed) tethering points that are engineered as tether points.
- Ensure there is adequate clearance in the event of a tool drop. Make sure there is room for the tethered tool to swing or fall so that you do not endanger yourself, other personnel, or any surrounding equipment or materials.
- Do not use KNIPEX Lanyards, Adapter Straps, TetheredTool Clips and Tethered Tools in extreme temperatures. The materials and components may not perform appropriately and can be damaged at temperatures below -35°C/-30°F or above 45°C/113°F.
- Do not use the loop for abridged connection to tether tools (See Figure 8).

A yellow rectangular sign with a black border. On the left side, there is a black triangle containing a white exclamation mark. To the right of the triangle, the word "CAUTION" is written in bold, black, uppercase letters.

- All incidents of dropped tools should be reported to supervisory or safety personnel. Lanyards, Adapter Straps, TetheredTool Clips and KNIPEX Tethered Tools involved in any such incident must be inspected for damage (See Section 4 Inspection).
- Lanyards or Adapter Straps should not be used at full extension. Such usage can overstress and damage materials or components.

2 Design and function

2.1 Design and capacity of the Lanyard and Adapter Strap for KNIPEX tools up to 3.3 lbs. (1.5 kg)

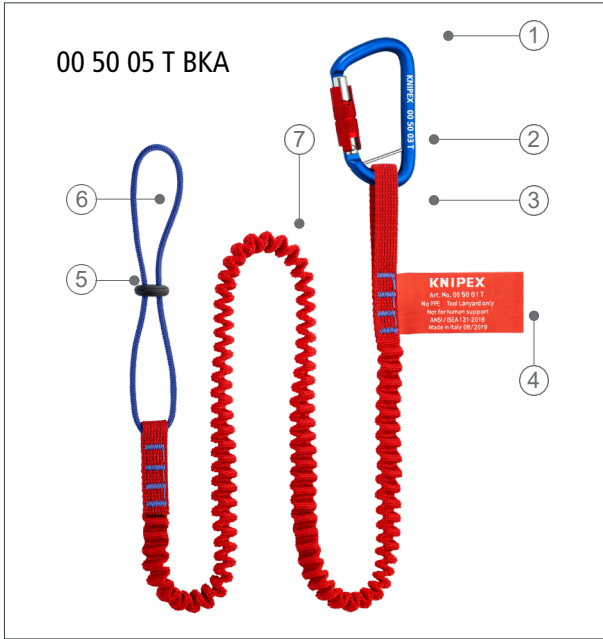

Figure 1: Terms and definitions - Lanyard, 3.3 lbs. (1.5 kg)

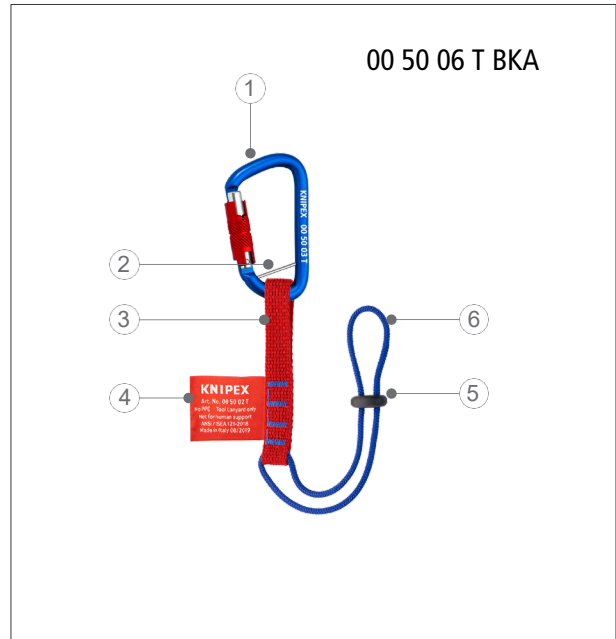

Figure 2: Terms and definitions - Adapter Strap, 3.3 lbs. (1.5 kg)

2.2 Design and capacity of the Lanyard and Adapter Strap for tools up to 13 lbs. (6 kg)



Figure 3: Terms and definitions - Lanyard 13 lbs. (6 kg)

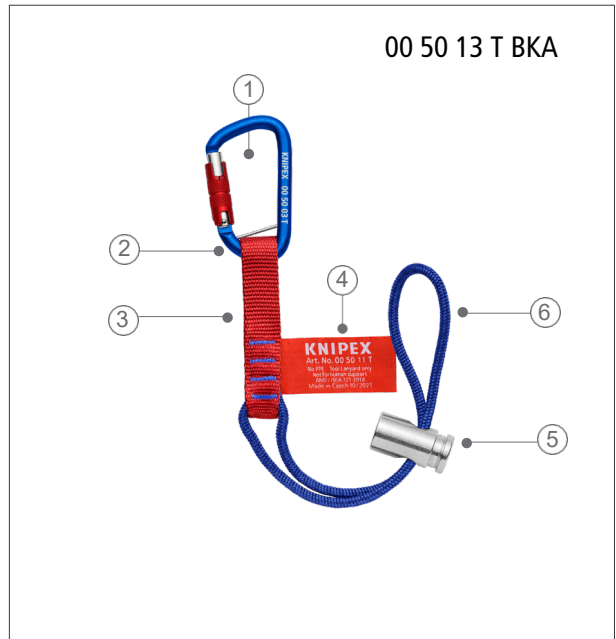

Figure 4: Terms and definitions - Adapter Strap 13 lbs. (6 kg)

- 1 Carabiner
- 2 Captive eye
- 3 Carabiner
- 4 Label
- 5 Cord stop
- 6 Loop end
- 7 Lanyard
- 8 Flat belt loop for abridged connection (only for 13 lbs. (6 kg) Lanyard)

2.3 Function

Tools within the capacity for any component and which have a captive tethering point can be tethered with the KNIPEX Lanyards and Adapter Straps.

3 Operation

3.1 Connecting the Lanyard to the tool

- The Lanyard should only be used with compatible KNIPEX components.
- To connect a KNIPEX Tool with tethering to the 13 lbs. (6 kg) Lanyard (KNIPEX 00 50 12 T BKA) you must use the 3.3 lbs. (1.5 kg) Adapter Strap (KNIPEX 00 50 06 T BKA) (Figure 5). The cord of the 13.2 lbs. (6 kg) version is too thick to thread through the tether point on the tools.
- KNIPEX Tools with a tethering point should only be connected by loop (Figure 8).
- Never use the flat belt loop for abridged connection for tethering (Figure 12).
- Attach the loop end of the Lanyard or Adapter Strap to a tool.

3.1.1 Attaching the KNIPEXTEND Tethered Tool Clip (TTC) to the KNIPEX tool with 3 Component Comfort Handles with Slots

WARNING

Warning – damaged components

- Before each use, visually inspect the KNIPEXTEND TetheredTool clip and the slot on the tool for integrity (e.g. cracks, damage, sharp edges, or deformation).
- Damaged components can fail and cause injury.

WARNING

Warning - incompatible components

- Only connect the KNIPEXTEND TetheredTool Clips with the KNIPEX 3 Component Comfort Handle tools with Slots
- Incompatible components can fail and cause injury.

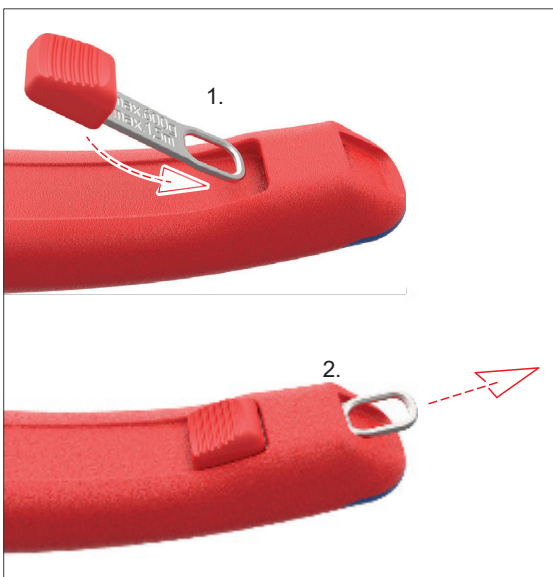

Figure 5: Attaching the KNIPEX TetheredTool Clips

1. Push the clip from the inside into the slot on the tool handle.

2. Push the clip all the way into the slot to create a fixed connection

3.1.2 Connecting the 3.3 lbs. (1.5 kg) Lanyard and / or Adapter Strap when using the KNIPEXTEND TetheredTool Clip (TTC) and the KNIPEX Engineered Tether Point – Part # 00 50 05 T BKA & 00 50 06 T BKA

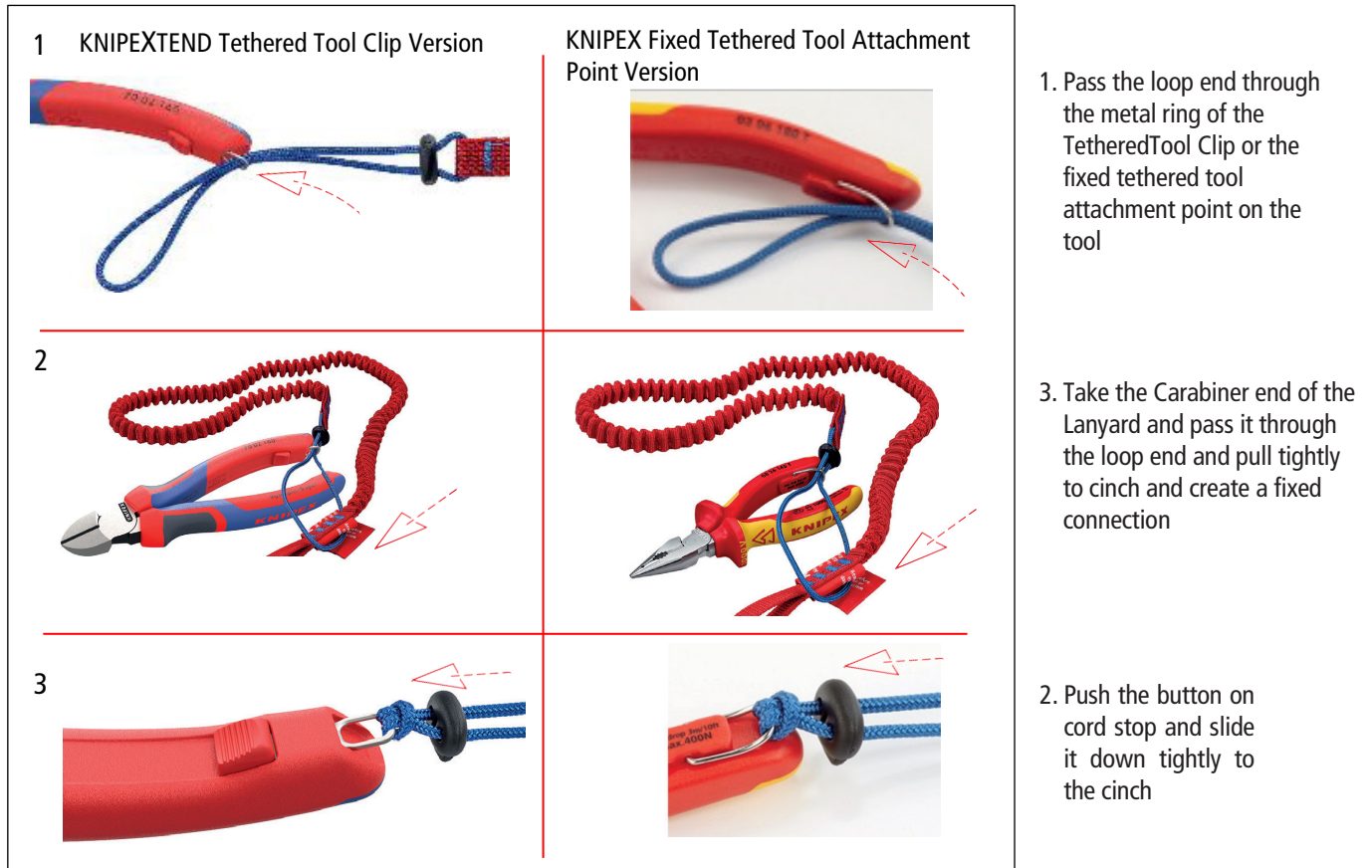

Figure 6: Attaching the Lanyard and / or Adapter Strap loop end to the multiple KNIPEX Tethered attachment options

3.2 Connecting the 13 lbs. (6 kg) Lanyard to primary anchoring locations (body, lifting device, or structure)

Figure 7: Lanyard anchored to a structure.



1. Tools that exceed 5 lbs. (2.26 kg) must be anchored to a structural anchor or lifting device, not to the user's body.
2. The best practice is to always anchor your Lanyard to a structure other than the user's body. If the user does anchor the Lanyard to their body, take great care selecting the anchor location and always be sure to have a secure stand, because falling tools can make you lose your balance.
3. For any questions or concerns about selecting appropriate anchor points, consult supervisory or safety personnel.

Attach the other end of the Lanyard to an anchor point that is suitable for tool tethering either by loop or by a carabiner (see [Section 3.1, figure 8](#)).

3.3 Using the tethering system

- Always keep tools tethered while working at heights. When exchanging tools, use a 100% tie-off by ensuring the tool is tethered to a secondary anchor before disconnecting from the initial anchor point.
- When using KNIPEX Tool Lanyards and Adapter Straps, determine the fully stretched length of the Lanyard used,

plus the length of the Adapter Strap if used, plus the tool itself. Add an additional safety factor to ensure an adequate clearance between where the Lanyard is anchored and the nearest person or object.

3.4 Using the abridged connection point

The 13 lb. (6 kg) version of the Lanyard (Part # 00 50 12 T BKA) is equipped with a second flat belt loop for abridged connection (see figure 3, Pos. 8). A second carabiner, which is hooked into this additional flat belt loop, can bridge the elastic part of the Lanyard. This prevents the tool from hanging down far and the abridged connection keeps the tool closer to the attachment point when the tool is not in use.



Figure 8: Abridged connection point for up to 13 lb. tools

⚠ WARNING

- The flat belt loop for abridged connection must never be used to secure a tool for fall protection (figure 9).

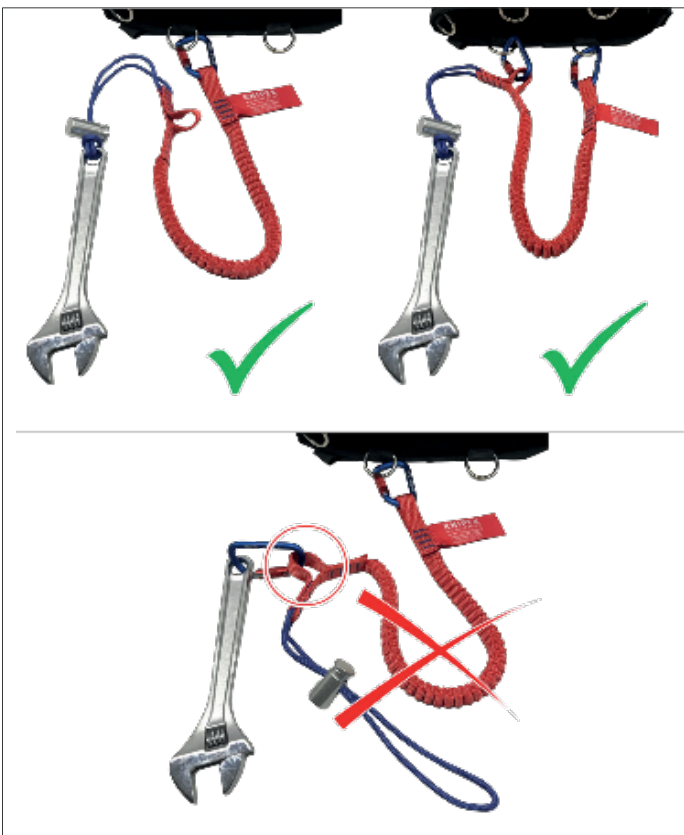

Figure 9: Using the abridged connection to connect to tools

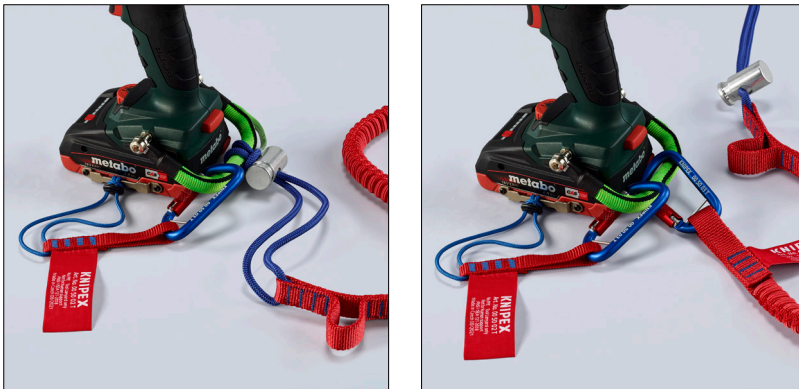

Figure 10: Attachment to a battery tool (over the loop or via carabiner)

Note: For battery operated tools, the battery should also be attached to the tethering system.

4 Inspection

KNIPEX Tethered Tool System equipment and components must be thoroughly inspected before each use. Any KNIPEX Tethered Tool System component that has damage, deformities, unusual wear, or deterioration must be immediately removed from service and destroyed.

Inspect the entire surface of the component, carefully rotating it while visually inspecting for damage or wear. Inspect material and stitching, hardware, carabiners, D-Rings and connectors. In any doubt, please ask your supervisor for help.

Remove KNIPEX Tethered Tool System components from service if damaged (see figure 11).

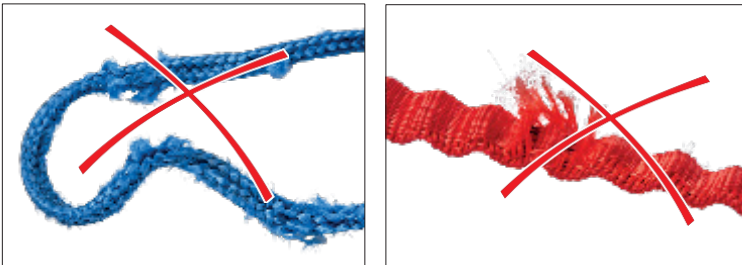

Figure 11: Remove KNIPEX Tethered Tool System components from service if damaged

Do not use tools with KNIPEXTEND TetheredTool Clip if the clip is deformed or has sharp edges (see figure 12).

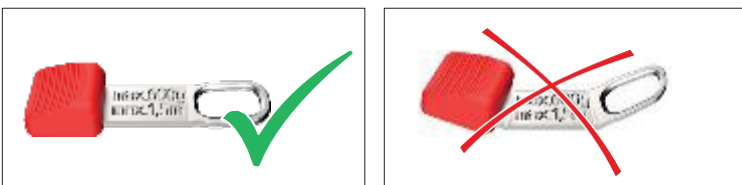

Figure 12: Do not use tools when clip is deformed or has sharp edges

Do not use the KNIPEXTEND TetheredTool Clip if the handle of the tool or the slot is damaged (e.g. due to cracks) (see figure 13).

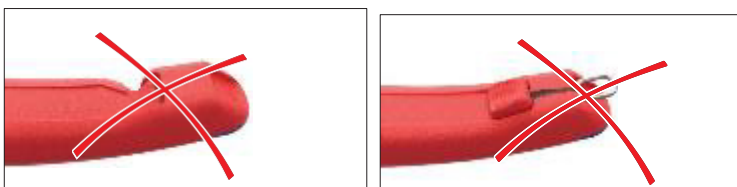

Figure 13: Do not use the KNIPEXTEND TetheredTool Clip if the handle of the tool is damaged

5 Storage and Care

- Store tool Lanyards and Adapter Straps in a clean and dry location away from direct sunlight and heating systems.
- To clean, use mild soap and water. Allow Lanyards and Adapter Straps to air dry only.

6 Product Overview and Technical Data

6.1 KNIPEXTEND TetheredTool Clips (TTC) and ColorCode Clips (CCC)



Product No.	Type	Quantity	Color
00 62 10 TR	TetheredTool Clips	10	red
00 63 06 TCR	TetheredTool Clips + ColorCode Clips	3 each	red

6.2 Lanyards and Adapter Straps with Captive Eye Carabiner

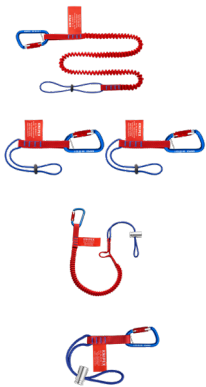

Product No.	Description	Relaxed length	Stretched length	Load rating	Compatible with TTC
00 50 05 T BKA	Lanyard with Carabiner	38" (1080 mm)	60" (1580 mm)	3 lbs. (1.5 kg)	•
00 50 06 T BKA	Adapter Strap with Carabiner with captive eye (qty 2)	13" (340 mm)	13" (340 mm)	3 lbs. (1.5 kg)	•
00 50 12 T BKA	Lanyard with Carabiner with captive eye	38.6" (980 mm)	61.8" (1570 mm)	13 Lbs. (6 kg)	–
00 50 13 T BKA	Adapter Strap with Carabiner with captive eye (qty 1)	16" (480 mm)	16" (480 mm)	13 Lbs. (6 kg)	–

7 Certified Safety



The products are tested and conform according to ANSI ISEA 121-2018.

The usability and loading capacity of the Lanyard have been independently tested and certified.

(VPA TESTED by VPA Prüf- und Zertifizierungs GmbH, 42859 Remscheid Germany)

8 Compatibility to KNIPEX Tools with Tethering

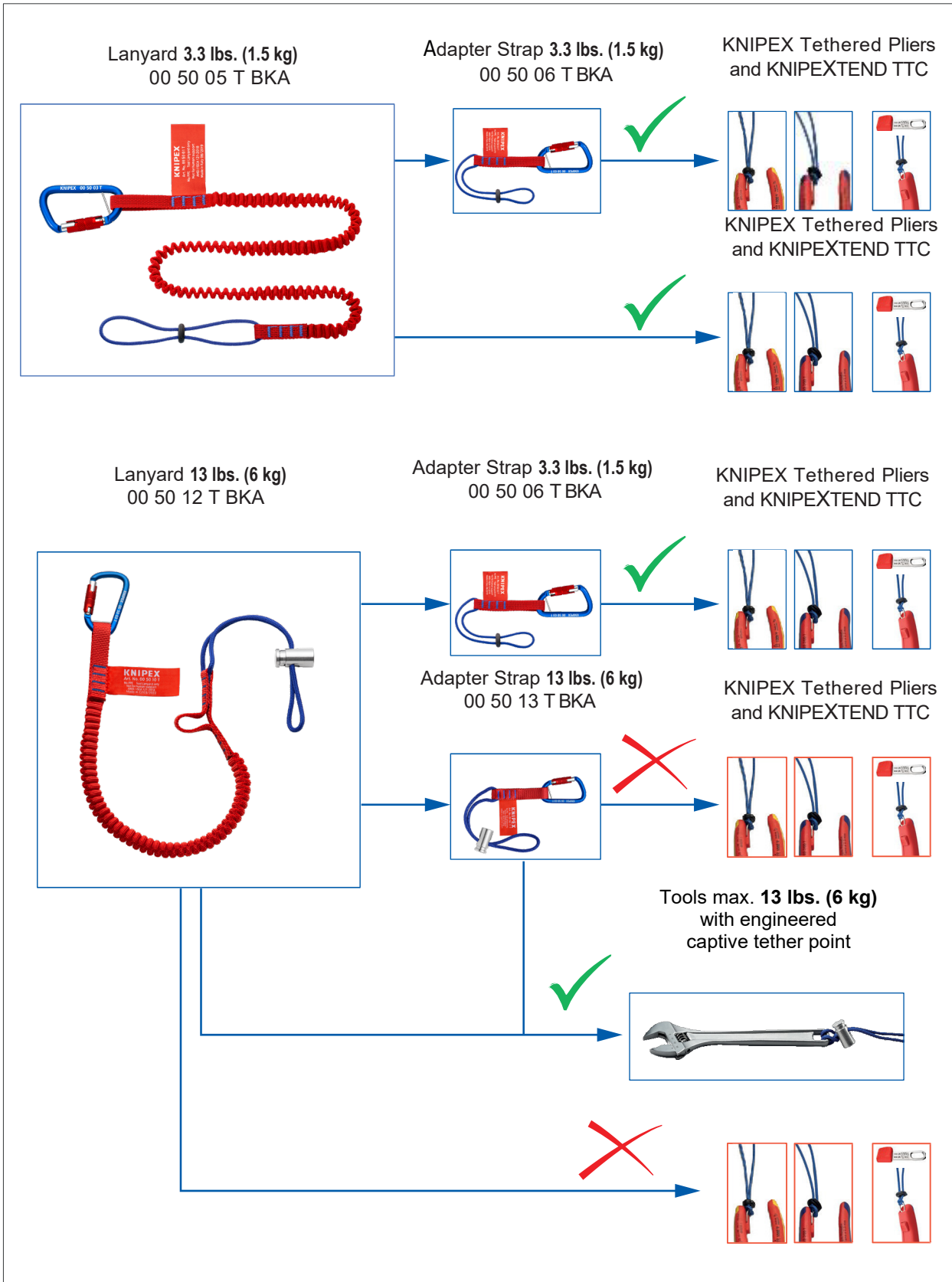

Figure 14: Compatibility to KNIPEX Tools with Tethering



KNIPEX-Werk
C. Gustav Putsch KG

42337 Wuppertal

Tel.: +49 202 – 47 94-0
Fax: +49 202 – 47 74 94

www.knipex-tools.com